

Thank you for your interest in hiring Bankside Gallery, home to the Royal Watercolour Society (RWS) and Royal Society of Painter-Printmakers (RE), where we celebrate the very best in contemporary watercolour and original printmaking.

In addition our own programme of exhibitions, for just ten weeks a year Bankside Gallery showcases the work of like-minded artists, art societies, galleries and curators.

We enthusiastically champion the work of both new and established artists, and welcome exhibition proposals in all forms of media.

As the home of two prestigious Royal Societies, all exhibition proposals are vetted by the current Society Presidents to ensure they align with Bankside Gallery's artistic values.

BANKSIDE GALLERY

EXHIBITION HIRE



"I wanted to write and say thank you for helping us deliver such a brilliant exhibition last week. We could not have done it without you and your team - who were just brilliant!"

Linda Palmer, Master, The Worshipful Company of Broderers - March 2025

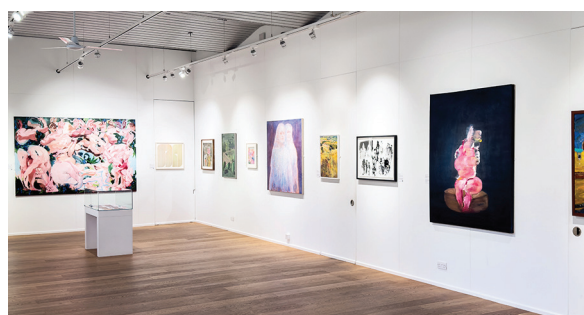

LOCATION

Bankside Gallery is situated on the Thames river front, directly beside Tate Modern, in the Bankside area of London; a vibrant cultural quarter, also rich in local character and history.

"Working with Bankside Gallery over the past three years to showcase the finalists of Jackson's Art Prize has been a fantastic experience. The team is not only friendly and professional, but also incredibly responsive to our questions and ideas.

The space is centrally located, and the gallery's size allows us to exhibit a substantial number of pieces while still giving each artwork the space it deserves.

Josephine Zentner, Jackson's Art Prize, July 2025

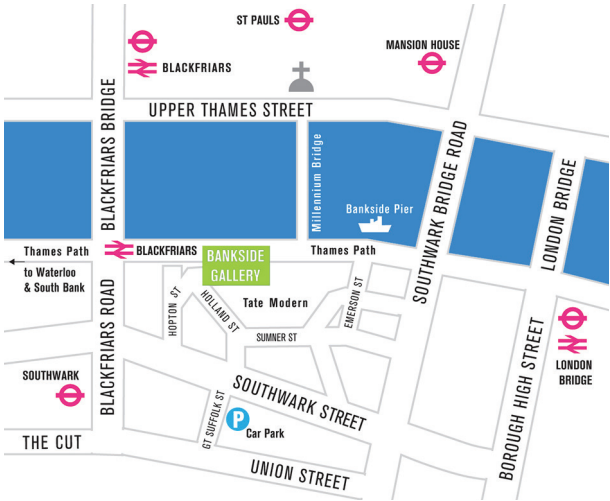

Easily accessible by public transport, we are next door to Blackfriars Rail Station (southside) and within walking distance of London Bridge and Southwark Stations.



THE SPACE

Bankside Gallery is on the ground floor and consists of one main exhibition space which is approximately 200 square metres with 100 square metres of hanging space.

The wall height is 3.5 metres. The Gallery is well lit with low energy lighting, with a spacious and contemporary feel.

The Gallery is open seven days a week during exhibitions, from 11am – 6pm. The entrance is from the riverside with wheelchair access both inside and out.

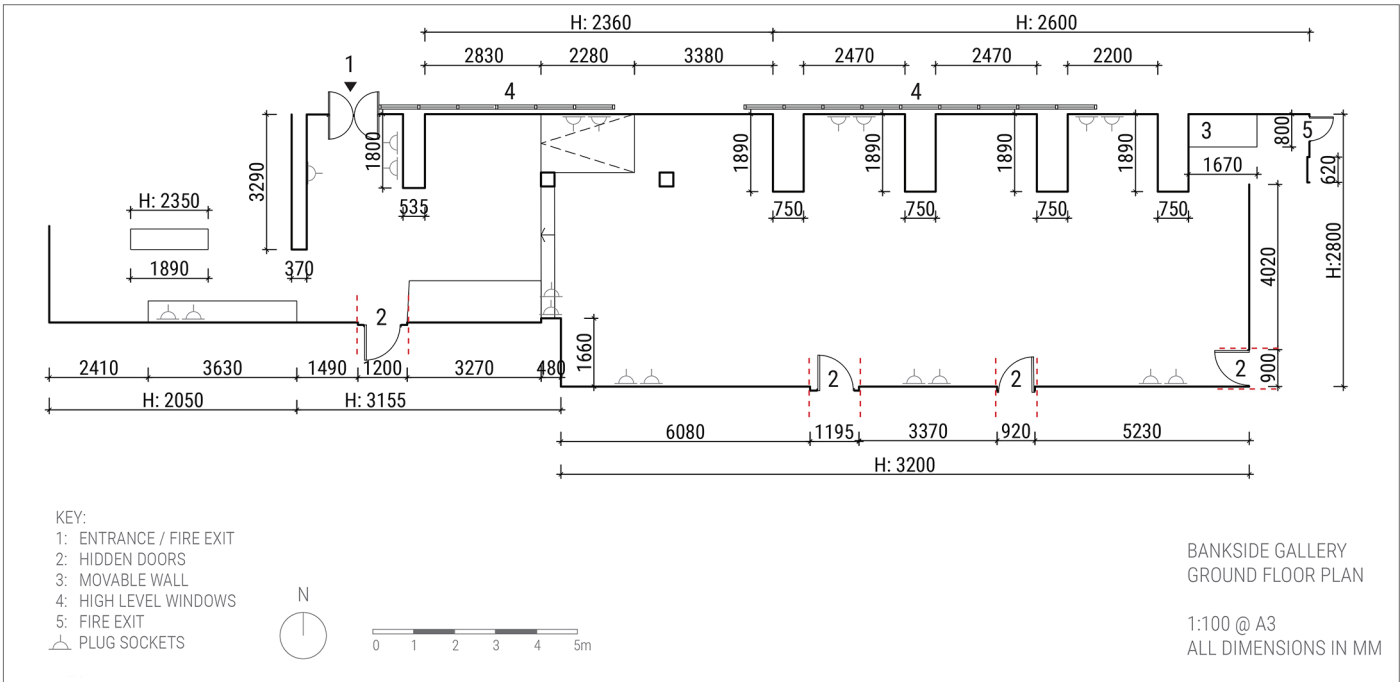

COSTS

Bankside Gallery is available for hire on a week by week basis from Monday - Sunday.

For 2026 the hire fee is £9,000 plus vat per week, and we take no further commission. Special rates or discounts may be available for charitable institutions.

A non-refundable deposit of 20% of the hire fee is payable on acceptance of the booking, and signature of the contract. The remaining payment falls due six weeks before the start of the exhibition.



You may hang the work yourselves or employ our experienced freelance technicians. All framed artworks must be secured to the walls with mirror plates to be covered by our insurance.

We can also assist with designing of posters and a 3 metre wide banner which hangs on the exterior of the gallery, attracting visitors from the busy Thames Path.



The hire fee includes

- one Private View, or similar evening event, per week of exhibition hire
- an experienced receptionist for the duration of your exhibition to welcome visitors and process sales
- listing on the Bankside Gallery website, and exhibition leaflet, promotion through our social media channels, and our e-newsletter mailed to over 12,000 active subscribers

For further information please contact Angela Parker, Gallery Director at aparker@banksidegallery.com

Previous exhibitors include

Sir Quentin Blake CH CBE
official war artist Linda Kitson
Society of Wood Engravers
The Worshipful Company of Broderers
Society of Designer Craftsmen
The Royal Society of Miniature Painters,
Sculptors & Gravers
printmaking collective LOOP
Printmakers Council
Jackson's Art Prize
Eton College
George Butler
Edward Hutchison
Laurel Holloman
and many more



We can't thank you enough for all the hard work on selling, publicity, marketing, finance, installing and deinstalling... We are delighted with how it all went and were so grateful for the daily updates and stellar communication throughout. Quentin is delighted with how it all went too and sends his gratitude. Looking forward to the next one already!

Sophie Stericker, General Manager, Quentin Blake Ltd
- July 2024

